

# *Sabrina*

Ergonomic Mesh Chair

---



okamura



*Sabrina*

**Design - Function - Variation - Quality - Ecology**



Design

## Giugiaro Design

The famous Italian industrial design firm Giugiaro Design collaborated with Okamura to create the SABRINA chair.

Now it is SABRINA with its innovative ring structure not only aesthetically beautiful but with the organic frame design and mesh backrest functions, which caress the body to ease the tension in the office. It is no less a signature of GIUGIARO, reflecting the design philosophy based on the structure of the body.



## Giorgetto Giugiaro

Born in Italy in 1938, Giugiaro began designing at age of 17 at the Fiat Style Center. At 21, he joined the Bertone Styling Center. In 1986, he went freelance and established Italdesign Corporation. In 1981, he founded Giugiaro Design. His countless innovative designs have made him one of the world's leading industrial designers.



**Add Harmony and Creativity to your entire office space**

Whether used with your workstation, conference room or reception space, Sabrina's simple and sharp design harmonizes with any kind of environment to create an refreshing ambience.



Chair Scene

**Brings extra vitality to your team work areas and individuality to your private office.**

Sabrina's innovative and refined design is a triumph of sharpness and simplicity.

Sabrina's seamless merging of color and style has freshness and vitality that effortlessly brings out the character of private work spaces, executive offices, and creative work areas.

okamura

## Ergonomic Concept

### Ankle Tilt Reclining Mechanism

Ankle tilt reclining is a mechanism by which the chair seat sinks backward in sync with the reclining of the chair back. This Mechanism naturally follows body movement even while working at a computer.

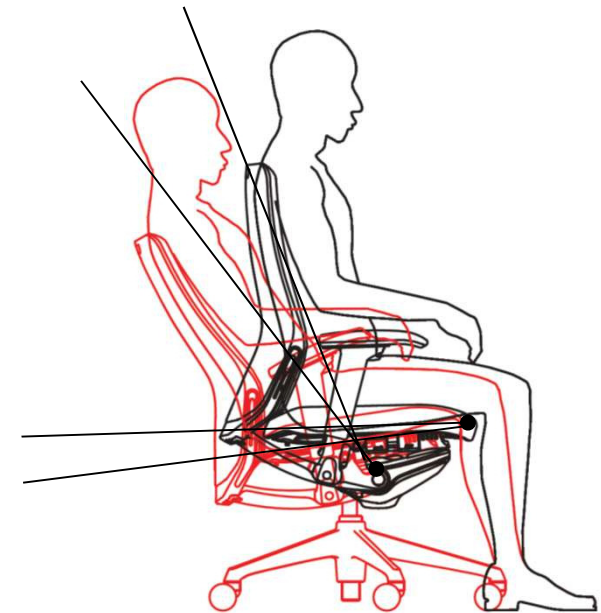



Function



# *Sabrina*

Standard

01



Smart Operation

02



Sabrina showcases the beautiful marriage of design, function and comfort.

Standard

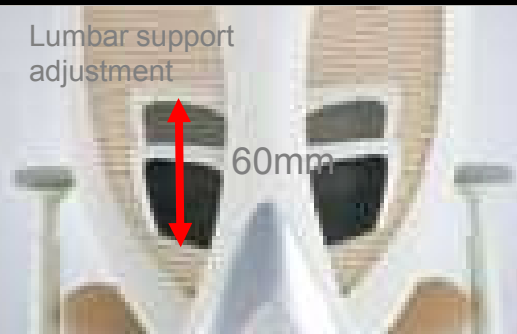

# Smart Operation

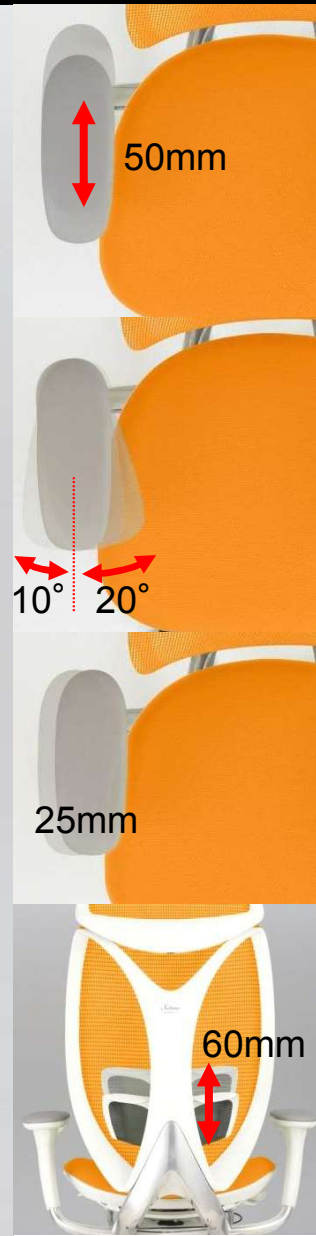
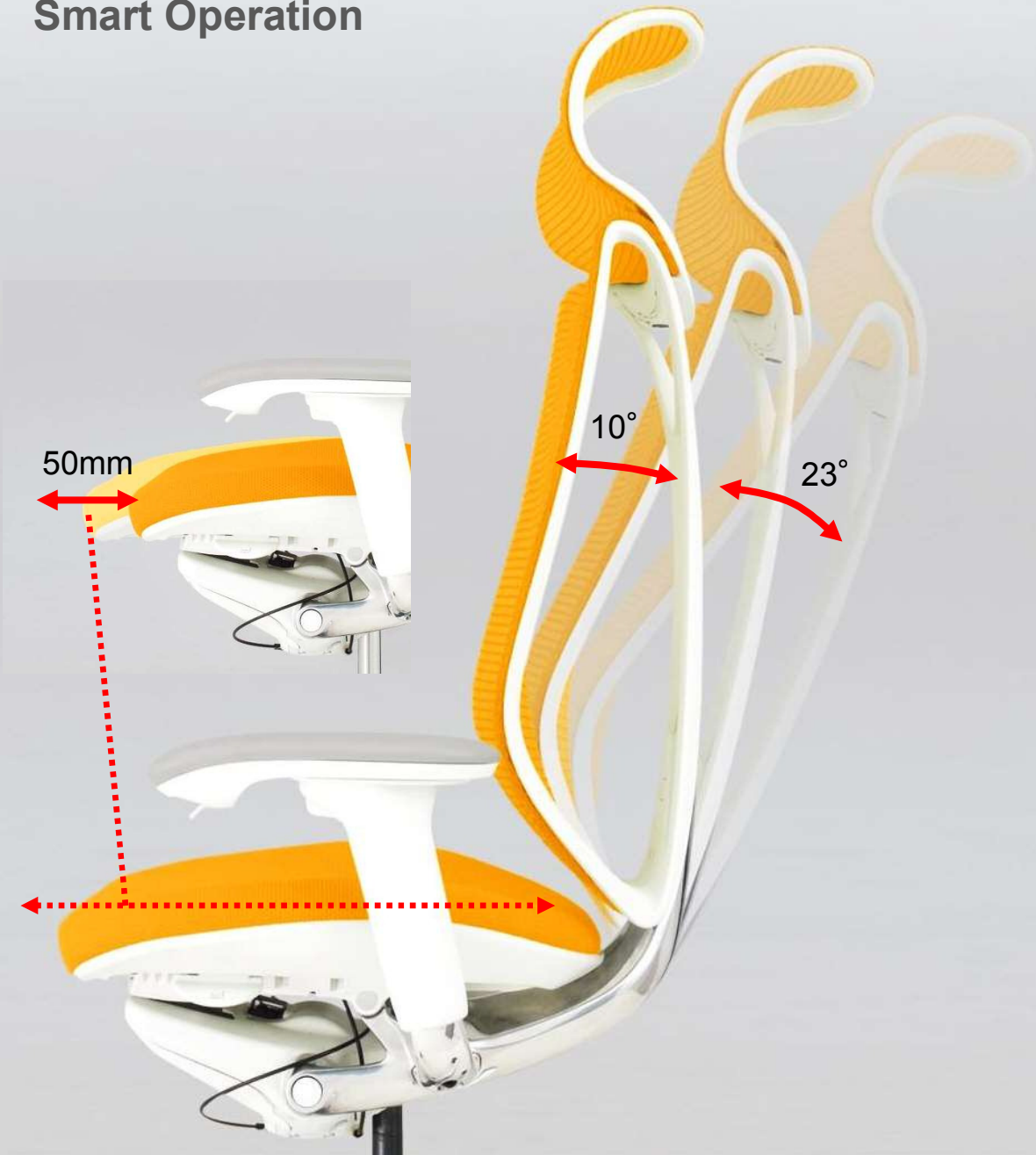

Moving beyond traditional concepts to  
“Smart Operation”



Seat height adjustment



Reclining lock and release

\*Smart Operation type only

## Ring Frame Structure



bend



twist

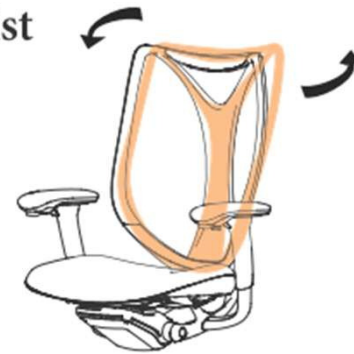

The center frame firmly supports the person sitting, the side frame, dividing left and right, allows for an adequate amount of bending to follow the weight distribution of the body.

A highly permeable mesh fabric provides a flexible and comfortable sitting condition.



Variation

Smart Operation

01

High Back



White body



Black body

02

Extra high-Back



White body



Black body

Standard

01

High Back



White body



Black body

02

Extra high-Back



White body



Black body



## 14 Mesh / Fabric variation

### Anti Scratching Fabric

The Surface of this seats are anti-scratching and won't be easily damaged by hard materials such as car keys.



**Body color**



white

**Armrest (only for standard)**



No armrest

**Options**



Hanger



Black



with armrest



Headrest

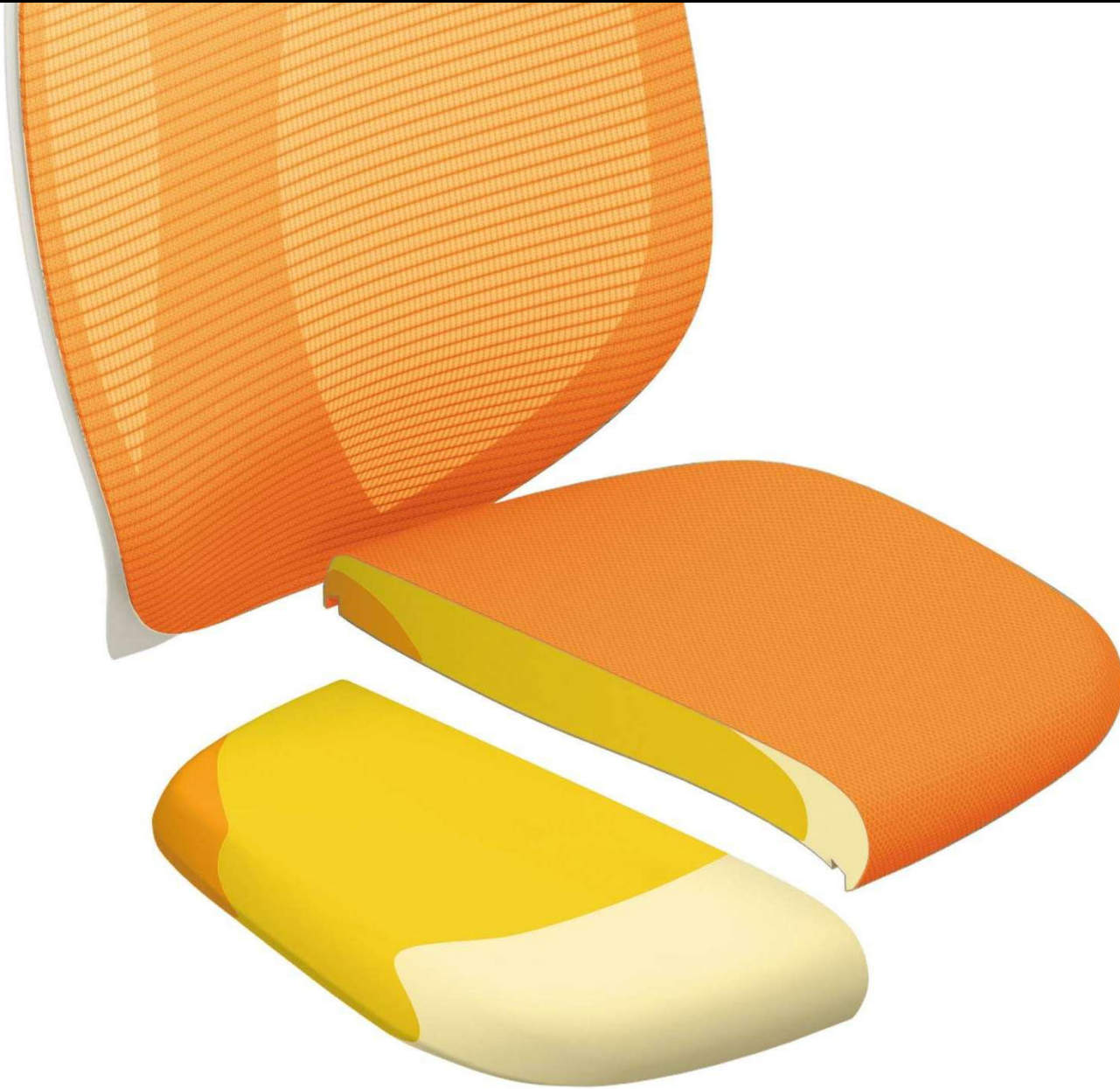

Quality

# Made in Japan



- 11 domestic Plants
- 1 Overseas Plant
- 96 Domestic Branches
- 8 International Branches



Tsukuba Site



Takahata Site\*



New Otani Site

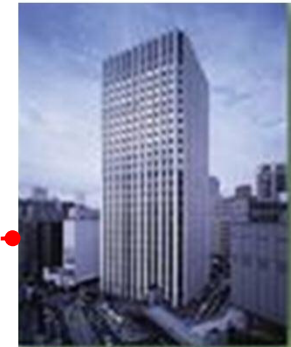

Head office Site (Tenri Bldg)

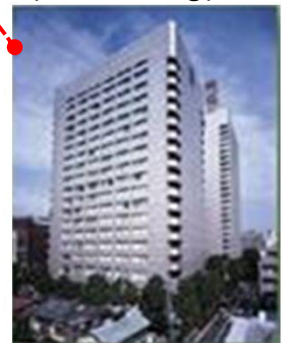

Sales Site (Kokusai Bldg.)



Fuji Site



Nakai Site



Oppama Site



We **Okamura** ensure the best in Quality.

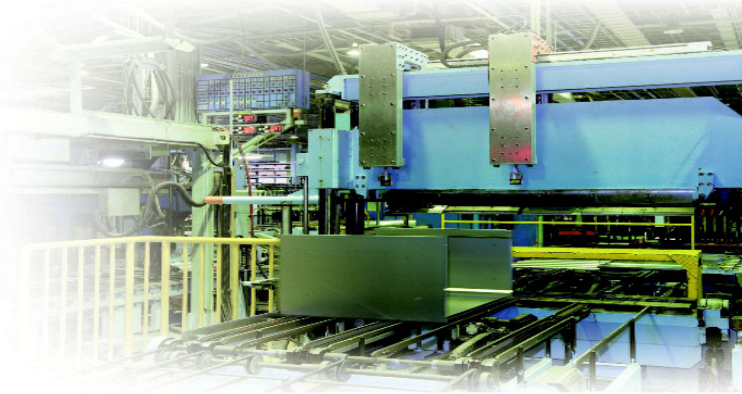
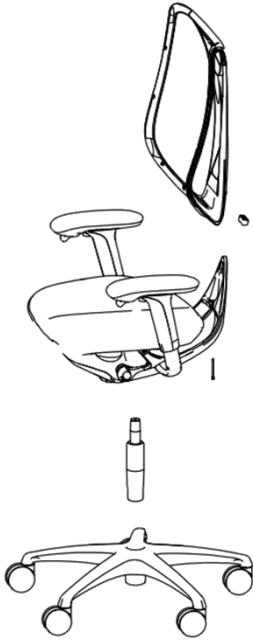

## Built with Pride and Quality.

In 1945, aviation engineers founded Okamura. Since then, we have developed the Japan's first torque converter, manufactured the Japan's first FF automatic transmission car, and have been the successful office furniture manufacturer. The founders' passion and persistence to manufacture the best products has been passed on to the employees today.



It is an International award chosen for the best design product by universal design award and interior innovation award in 2013.



GREENGUARD is an indoor environment air quality standards used to certify products with low chemical emissions for the protection of interior environments. Sabrina Smart Operation received GREENGUARD certification in October 2013.



Japan's only comprehensive design evaluation and commendation certificate. This award is given to products that encompass "improving the quality of lives and advancing industry" through "design"



Eco  
Friendly

## SABRINA standard - Sustainable Design

Eco-conscious products are the latest trend in furniture design.

Recycled materials: **31%**

Recycled materials are used in aluminum and resin parts. These materials make up about 31% by product weight.

Recyclability: **100%**

With future recyclability firmly in mind during the design stage, we use homogeneous materials as much as possible. After use, our products can be collected and disassembled into homogeneous materials.

### Indicating materials

Okamura indicates the materials used to facilitate recycling after use.

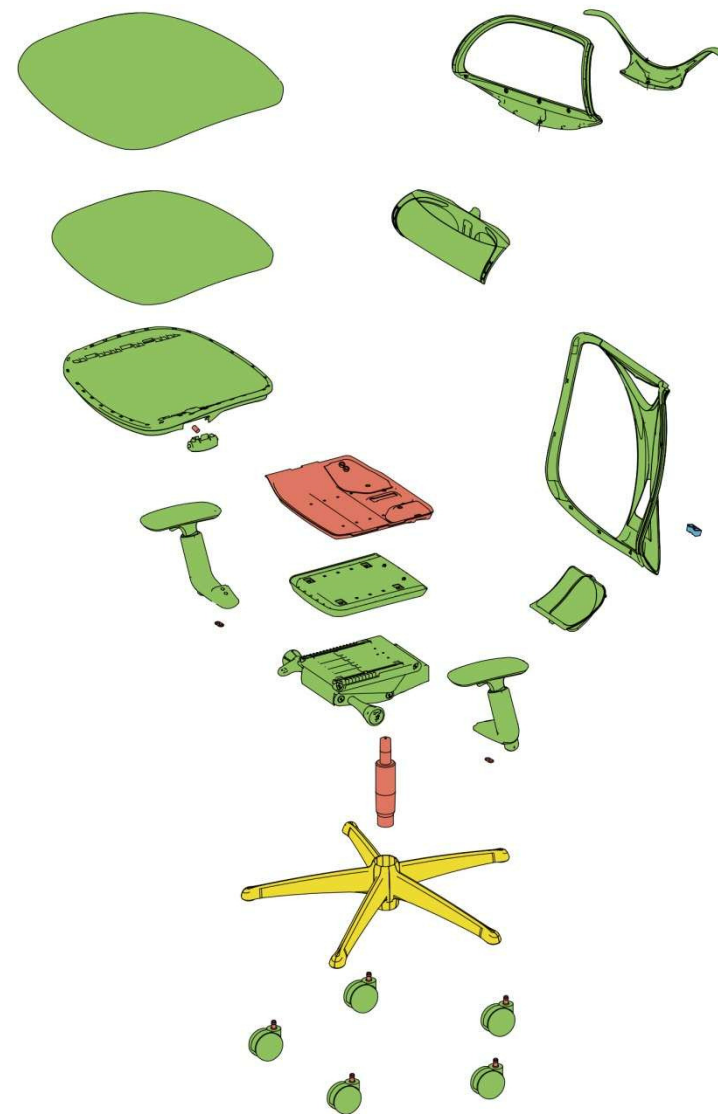

## SABRINA Smart Operation - Sustainable Design

Eco-conscious products are the latest trend in furniture design.

Recycled materials: **46%**

Recycled materials are used in aluminum and resin parts. These materials make up about 46% by product weight.

Recyclability: **100%**

With future recyclability firmly in mind during the design stage, we use homogeneous materials as much as possible. After use, our products can be collected and disassembled into homogeneous materials.

### Indicating materials

Okamura indicates the materials used to facilitate recycling after use.

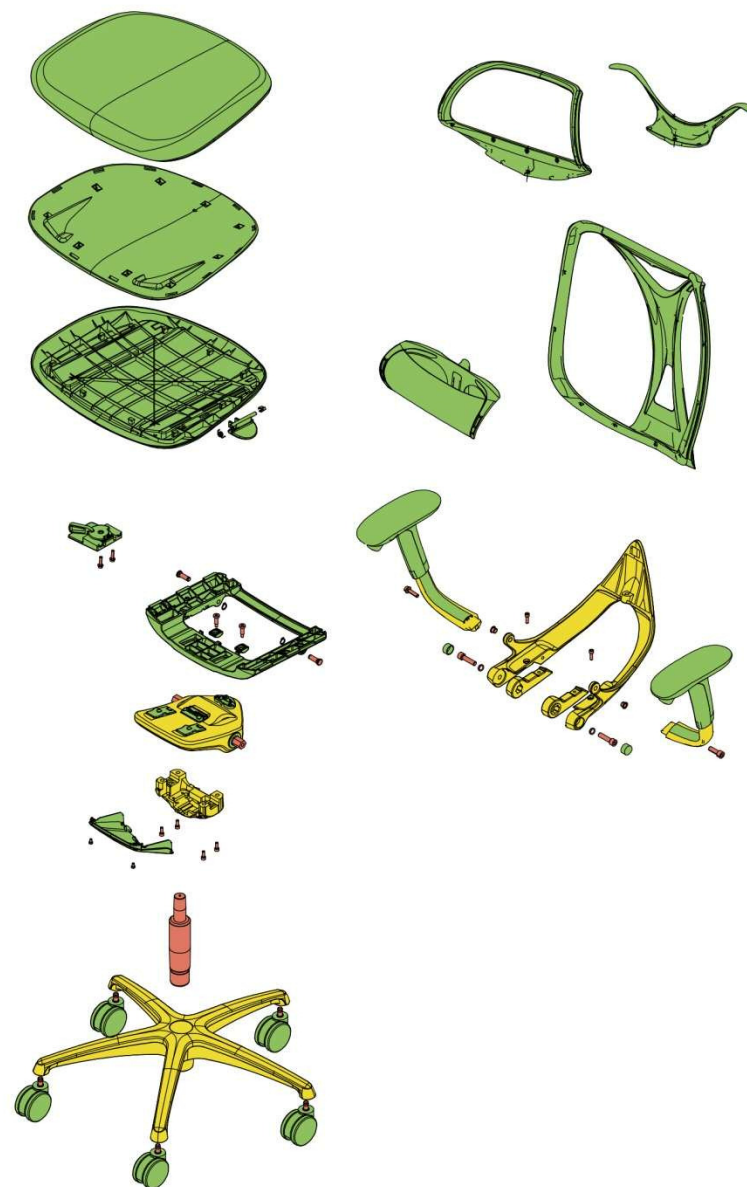



Our products are loved world wide.

**HITACHI**



 **TOYOTA**



**CAMPARI**

**SONY**

**Panasonic**



 **MAERSK LINE**

**Canon**



**BRIDGESTONE**

ArcelorMittal

 **MITSUBISHI**

 **ERNST & YOUNG**

okamura







Thank You!

okamura